



TROPICAL BOTANIC GARDEN



www.museus.ulisboa.pt/
jardim-botanico-tropical

THE BOTANIC COLLECTIONS

The 7 ha of this Garden comprise important botanical collections covering about 600 species belonging to more than one hundred families, mostly of tropical and subtropical origin. In addition to species of economic interest, namely for food, medical applications and wood or fiber production, there are also rare species such as the cycads (*Cycas* spp. and *Encephalartos* spp.).

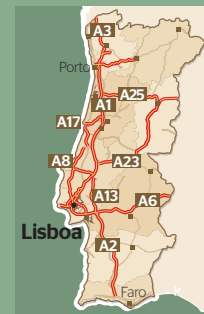

CONTACTS

Largo dos Jerónimos,
1400-209 Lisboa
www.museus.ulisboa.pt/
jardim-botanico-tropical
geral@museus.ulisboa.pt

Coordinates:
38.698128 | -9.203854

OPENING HOURS

Open every day
except December 25 and January 1
October-March: 10am - 5pm
April-November: 9am - 8pm

HOW TO GET HERE

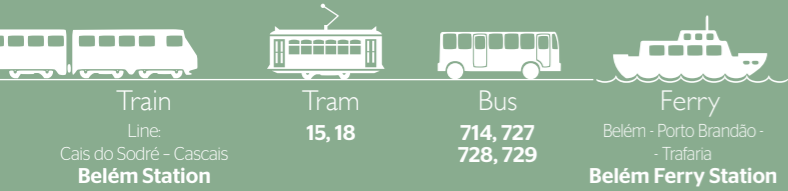

Created in 1906, the Tropical Botanic Garden was conceived to support tropical agronomy teaching. It holds an important collection of plants with economic value, selected to illustrate strong links with the Portuguese overseas exploration and their dissemination routes through the various continents by Portuguese navigators. The Garden also includes an exceptional architectonic and artistic heritage, dating from the 17th to the 20th centuries. In 2015, the Tropical Botanic Garden joined the University of Lisbon (as part of the Tropical Research Institute), and is presently managed by the National Museum of Natural History and Science. A restoration process was begun in 2019.

1 COLLECTION OF PLANTS WITH ECONOMIC VALUE

MAIN GREENHOUSE

The main greenhouse mainly hosts plants from hot and humid regions, such as *Aframomum melegueta* – grains of paradise, *Curcuma longa* – turmeric, *Manihot esculenta* – cassava, *Saccharum officinarum* – sugarcane, *Theobroma cacao* – cacao tree and *Zingiber officinale* – ginger.



Musa spp.
Banana tree

Coffea arabica
Coffee shrub

2 WASHINGTONIA ALLEY

Washingtonia robusta
Mexican fan palm

Washingtonia filifera
California fan palm

Sequoia sempervirens
Coast redwood



Ficus macrophylla
Moreton bay fig

3 MAIN LAKE

Encephalartos altensteinii
Bread tree

Cycas revoluta
Sago palm

Baucarnea recurvata
Elephant's foot tree

Tropical fruit trees



4 ORIENTAL GARDEN

Phyllostachys viridiglaucescens
Green glaucous bamboo

Berberis bealei
Leatherleaf mahonia

Bambusa vulgaris
Common bamboo

Aucuba japonica
Japanese laurel

Bergenia crassifolia
Siberian tea

Ophiopogon japonicus
Mondo grass



5 ALLEY OF CORAL TREE

Strelitzia nicotai
White bird of paradise

Araucaria cunninghamii
Hoop pine

Erythrina americana
Naked coral tree

Lagerstroemia indica
Crape myrtle

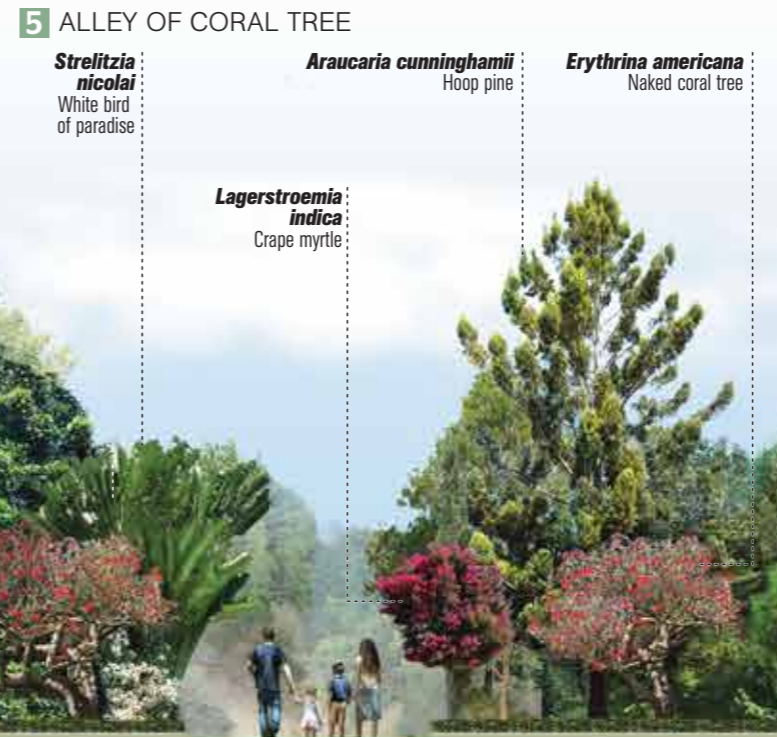

6 LAUREL FOREST FLORA

Juniperus cedrus
Canary Islands juniper

Ocotea foetens
Til

Laurus azorica
Azores laurel

Pèsea indica
Canary wood

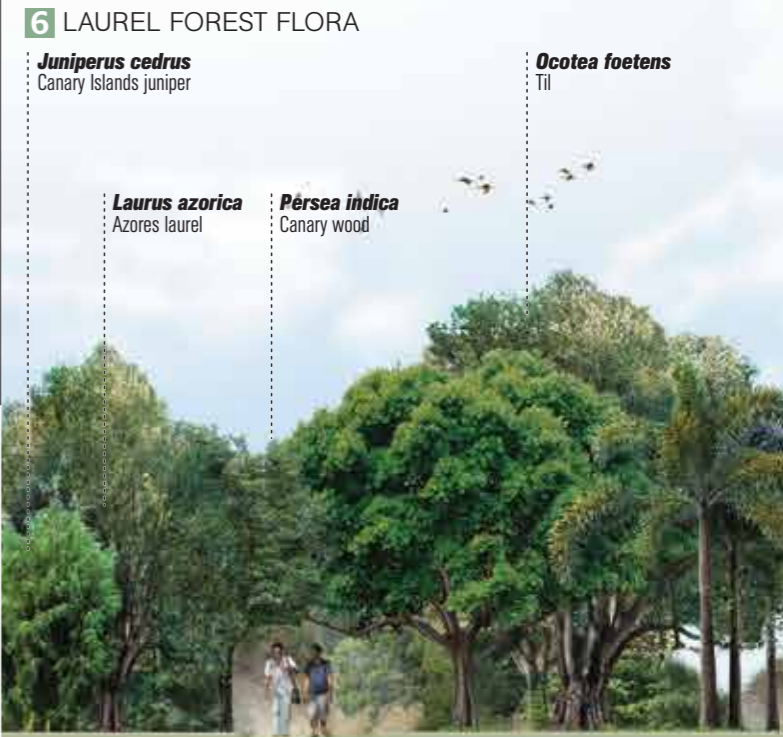

REMARKABLE SPECIES

Ficus macrophylla **A**
Moreton bay fig



Large fig tree with lignified aerial roots that extend to the ground. The fibers from the aerial roots are used by the local populations for textiles and fishing nets.

Dracaena draco **B**
Dragon tree



Arborescent plant with a top shaped like an umbrella. Its sap becomes red in the air and was widely used between the 15th to 18th centuries in painting, writing, medicine, furniture wax and varnish. Classified as Vulnerable in IUCN Red List of Threatened Species.

Afrocarpus mannii **C**



Tree confined to altitudes between 1450 m and 2024 m on the island of São Tomé (São Tomé or Gago Coutinho peak). It is used to provide shade and protect crops from the wind in western tropical Africa. Classified as Vulnerable in IUCN Red List of Threatened Species.

Ceiba speciosa **D**
Silk floss tree



This species is remarkable for its thorn-covered bottle-shaped trunk, as well as its attractive pink and white flowers blossoming in late summer, and seeds lavishly wrapped in fine fibers.

TROPICAL BOTANIC GARDEN

ULISBOA | UNIVERSIDADE DE LISBOA

TROPICAL BOTANIC GARDEN



Memory Church

PALACE OF THE COUNTS OF CALHETA

17th century noble building of remarkable interior decoration with magnificent 17th and 18th centuries Portuguese tiles (azulejos).

Cupressus sempervirens
Mediterranean cypress



COLONIAL SECTION OF THE 1940 PORTUGUESE WORLD EXHIBITION

The Portuguese World Exhibition took place in Lisbon in 1940. Ahead of commemorating simultaneously the foundation of Portugal in 1140 and its restoration of independence from Spain in 1640, the 1940 Exhibition was a major propaganda tool for the Estado Novo regime. The Exhibition's Colonial Section was located in this Garden (then called 'Colonial Garden'). Although elsewhere largely destroyed, several Exhibition buildings and statues were preserved, making the Tropical Botanic Garden an exceptional site of memory and heritage of the 1940 Exhibition.

Bauhinia purpurea
Butterfly tree

RAW MATERIALS PAVILION
Built for the Portuguese World Exhibition (1940).

MOON DOOR
Stylized replica of a door belonging to a pavilion of the A-Má Temple in Macau

CHINESE GARDEN PAVILION

CAMÕES CAVE
A tribute to the Portuguese poet Luís de Camões

TEA GREENHOUSE

ORIENTAL GARDEN
Receiving an oriental garden, the start of the Macao Garden is marked by the Macao Arch, a stylized replica of the portico of the A-Má Temple, in Macao

MACAO ARCH

Annona cherimola
Cherimoya tree

Syzygium cumini
Lambdian

Brahea edulis
Guaдалupe Palm
Endemic to the island of Guadalupe in the Caribbean. This specimen was planted in 1913 by the first President of the Portuguese Republic.

Casimiroa edulis
White sapote

Ginkgo biloba
Ginkgo

Aleurites moluccanus
Candlenut tree

Eugenia uniflora
Surinam cherry

Sequoia sempervirens
Coast redwood

Beaucarnea recurvata
Elephant's foot tree

MAIN LAKE
Constructed in 1903, on the occasion of the visit of King Alfonso XIII of Spain to the Portuguese Court, the lake is surrounded by luxuriant vegetation, which is an attraction for resident and migratory birds, especially mallards (*Anas platyrhynchos*), grey herons (*Ardea cinerea*), little egrets (*Egretta garzetta*), black-crowned night-herons (*Nycticorax nycticorax*), and common kingfishers (*Alcedo atthis*), among others.

Museum of the Presidency of the Republic

PARKING (NEARBY)

Ficus religiosa
Sacred fig

Fig tree with heart-shaped leaves exhibited in a narrow tip. All parts of the plant are used in Ayurvedic medicine. Sacred tree for Hindus and Buddhists.

Ficus sycamorus
Sycamore fig tree

Fig tree with figs on the trunks and branches. It is used as fruit tree and for medical applications. It is mentioned several times in the Bible. The wood was used in the sarcophagi of Pharaohs.

Araucaria bidwillii
Bunya pine

Araucaria with large cones that can reach 10 kg. The seeds are edible. It is a sacred tree in Australia.

Cinnamomum burmanni
Padang cassia

One of the species from which the most traded cinnamon is extracted

Yucca gigantea
Spineless yucca

Arborescent plant, imposing by its diameter and height. It has multiple stems dilated in the base surrounded by rosettes of leaves without thorns. The leaves are used in culinary.

Phytolacca dioica
Onchu

Herbaceous arborescent plant with a very thickened stem in the base and top with multiple pendent branches. The sap and leaves are used in traditional medicine.

Henrique Calado Riding Hall and Portuguese School of Equestrian Art

TEA ROOM
The 'Colonial Restaurant' of the 1940 Portuguese World Exhibition was here.

BUSTS
Currently dispersed in pairs, through the Garden, these 14 busts were originally displayed in the 'Gallery of the Peoples of the Empire' of the 1940 Portuguese World Exhibition.

EXHIBITION GALLERY
Presently used to support educational activities and events.

- CAPTION
- Monument
 - Museum
 - Church
 - Event
 - Parking
 - Garden
 - Information
 - Post office
 - Restaurant
 - Coffee shop
 - Accommodation
 - Wines
 - Police station
 - Facilities
 - Tickets
 - Shop
 - WC
 - Building entrance